

Aerator akavent

HDPE



| d ₁ | Art. Nr. | * | L | l ₁ | l ₂ | l ₃ | l ₄ | l ₅ | l ₆ | l ₇ | l ₈ | l ₉ |
|----------------|----------|---|-----|----------------|----------------|----------------|----------------|----------------|----------------|----------------|----------------|----------------|
| 110 | 60 11 07 | * | 750 | 320 | 170 | 260 | 275 | 90 | 180 | 55 | 130 | 90 |
| 160 | 60 16 07 | * | 715 | 320 | 160 | 235 | 310 | 100 | 200 | 75 | 125 | 110 |

* 1/2/3 = max. Ø 110 mm - 4/5/6 = max. Ø 75 mm
butt weld only

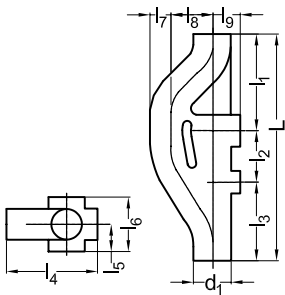
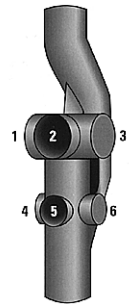

The akavent aerator interrupts the fall of the wastewater on every floor resulting in a reduction of the speed. The vent pipe is obsolete and the unique design increases the capacity of the riser.
The akavent aerator will be delivered with closed caps. After removing the caps, the required branches can be buttwelded to the aerator. Wenn the connection will be made with snap socket Art.Nr. 40xx10 a tight-fit plug-in connection is created. Then is a transition to other material also possible.